

Data sheet

Support roller NATV 17 PP (crowned, with axial guidance, full needle, seal)

Designation	NATV 17 PP
Type	crowned
D [mm]	40
d [mm]	17
d1 [mm max.]	32
B1 [mm]	21
B [mm]	20
r [mm]	1
Dynamic load Crw[N]	14800
Static load C0rw[N]	26500
Speed limit [min-1]	2900
Speed limit [min-1]	4700

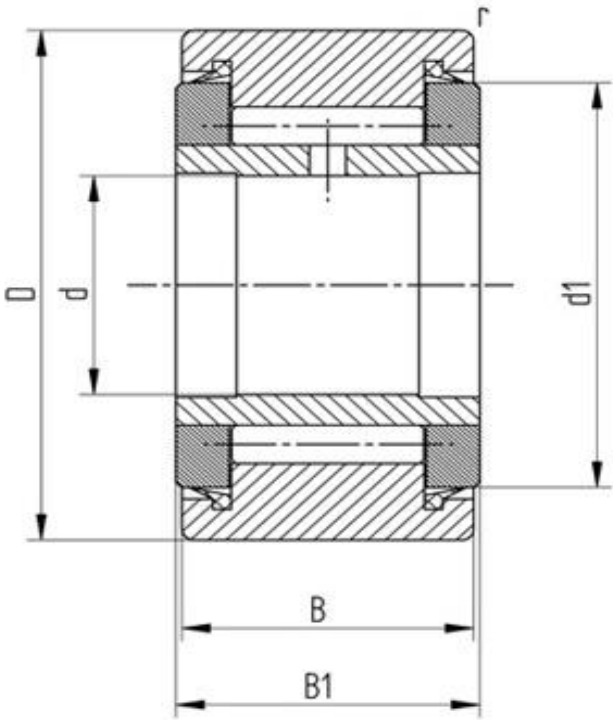

Every specification has been edited and verified carefully. STI Bearings GmbH assumes no liability for potential errors or incompleteness. Technical modifications are subject of changes.

© 2020 by STI Bearings GmbH

Reproduction, even excerpts, only with our approval.